

DF8M

Wireless smoke detector with sounder



Intrusion is not the only risk faced by homeowners and business managers. Fire is a leading cause of accidental death with 70% of fire related fatalities occurring at night. By installing smoke detectors that are managed around the clock through the intruder alarm system, tragedies could be halved - a fact which is proven in countries where 80% of homes are equipped with smoke detectors.

The DF8M is a new wireless photo-electronic smoke detector suitable for residential and commercial applications. It detects all types of smoke and has a built-in siren for compliance with the EN14604 European standard. When the DF8M is triggered, its integral sounder notifies occupants and the control panel sends a signal to the Alarm Receiving Centre (ARC) enabling swift action to be taken. Other messages which can be relayed to the ARC include tamper, maintenance, and battery condition.

End users benefit from peace of mind knowing that their smoke detectors are monitored round the clock for maintenance, as well as smoke detection, and service calls are automatically scheduled should the detector require cleaning or a replacement battery. Because the detector is wireless, it can easily be added to

existing wireless and hybrid intruder alarm systems without disrupting business operations or the decor of any home.

Thanks to proven wireless performance delivered through Honeywell's bi-directional radio technology and the sensor's advanced sensing chamber and advanced microprocessor, false alarms, non-billable service calls and resulting fines are virtually eliminated. Larger systems that use Galaxy Dimension also benefit from a more reliable signal transmission using its agile routing technology.

The DF8M provides new opportunities for installers and ARCs to offer fire protection and monitoring services to businesses and homeowners.

The DF8M wireless technology is part of a powerful solution, compatible with Domonial residential intruder alarm, as well as the G2 and Galaxy Dimension commercial control panels. This compatibility means installers need only stock one smoke sensor for all types of installations, reducing their financial and logistical stock burden. It is suitable for a wide range of environments, where security, practicality and peace of mind are real concerns for the end-user.

Features

State of the art optical sensing chamber

Detects all types of smoke using the light scattering principle with infrared light to measure the amount of smoke in the chamber every 10 seconds.

Advanced processor

Helps eliminate false alarms and automatically maintains correct operation at factory calibrated detection levels even when sensitivity is altered due to contaminants in the unit's smoke chamber.

Dual protocol sensor

Configuration to Alpha or V2GY protocols makes the DF8M compatible with all Honeywell control panels (Domonial, G2, Galaxy Dimension and Vista)

Built in piezoelectric sounder

Ensures maximum life safety by triggering an audible siren locally and meets requirements for compliance to new EN14604 European standard

Removable detector cover and chamber top

Allow engineers to quickly and easily clean the detector chamber without dismantling the detector head.

"Clean Me" signal

Sensor can identify a dirty chamber and signal a "clean me" message to the control panel.

LED indicators

Red and green LEDs quickly identify sensor status. A Green LED denotes a normal condition while the red LED indicates abnormal conditions such as power/operation status, maintenance required, smoke detected, and low battery.

Test button

Offers end user peace of mind and installers a swift method of testing the detector

Battery life

Long 4 or 5 year battery life (depending on protocol used) reduces maintenance costs

Full compliance with EN Standards

Designed in accordance with EN50130-4:1995, EN61000-6-3:2001, EN14604, Class B, Security Grade 2, Environmental Class II to meet all current legislative requirements. NF-DAAF & GOST-R approval pending.

DF8M

Wireless smoke detector with sounder

Specifications		
Detection	Coverage	100m ² (for wide open areas. It is recommended to install one sensor per room and every 7m for long corridors)
	Sensing technology	Photoelectric optical
	Supervision	Yes
	Warning alerts	Low battery detection "Dirty sensor" signal
	LED indications	Green & red LED
Power	Battery (supplied)	1 x 3V Lithium CR123A
	Battery Life	Alpha mode: 5 years V2GY mode: 4 years
Radio	Protocols	Alpha or V2GY (configuration by jumper)
	RF Type & Frequency	Narrow band, 868MHz
	Radio Range	2000m open field
Compatibility	Galaxy	G2 ⁽¹⁾ and Galaxy Dimension ⁽²⁾ with C079-2 wireless receiver
	Domonial ⁽³⁾	All 868MHz versions
	Vista	With 5882EUHS wireless receiver
Sounder	Output	85dB @ 3m
Mechanics	Tamper	Anti-tamper against opening
	Test/Hush button	Yes
	Dimensions (Ø x h)	135 x 58 mm
	Weight	241g without battery
	Operating temperature	-10°C to 55°C
	Storage temperature	-20°C to 70°C
	Relative humidity	0% to 95%
Mounting	2 screws	
Approvals	CE, EN14604, NF-DAAF & GOST-R pending	

Honeywell reserves the right to alter these specifications without notice.

Notes:

- (1) Valid for G2 panel firmware from V1.5 onwards
 (2) Valid for Galaxy Dimension panel firmware from version V6.5 onwards
 (3) Valid for Domonial panel firmware from version lxx onwards

Find out more:

www.honeywell.com/security/uk
 Fax: +44 (0) 1698 738300
 email: HSUK64SalesTeam@Honeywell.com

Honeywell Security Group

Newhouse Industrial Estate
 Motherwell, Lanarkshire
 ML1 5SB
 Scotland
 Tel: +44 (0) 1698 738200

Ampèrestraat 41
 1446 TR Purmerend
 Nederland
 Tel: +31 (0) 299-410200
www.honeywell.com

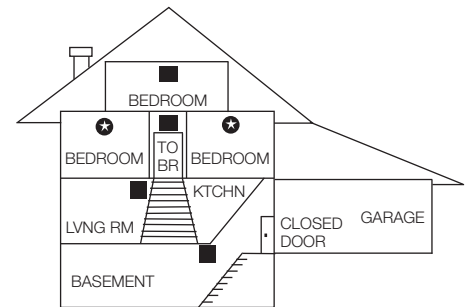

- Smoke Detectors for Minimum Protection
 ★ Smoke Detectors for Additional Protection

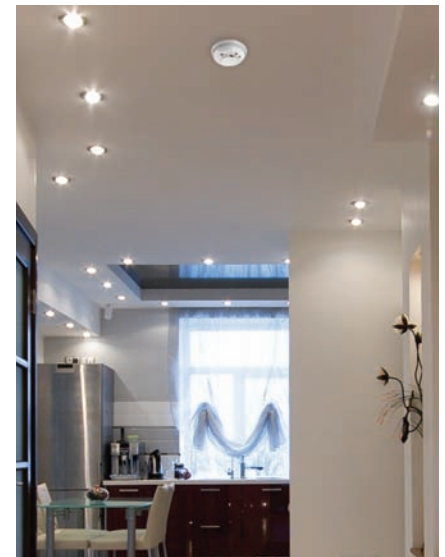

Ordering References

DF8M Wireless smoke detector with sounder
CR123 Lithium battery

Honeywell